

Solar access - January 21st

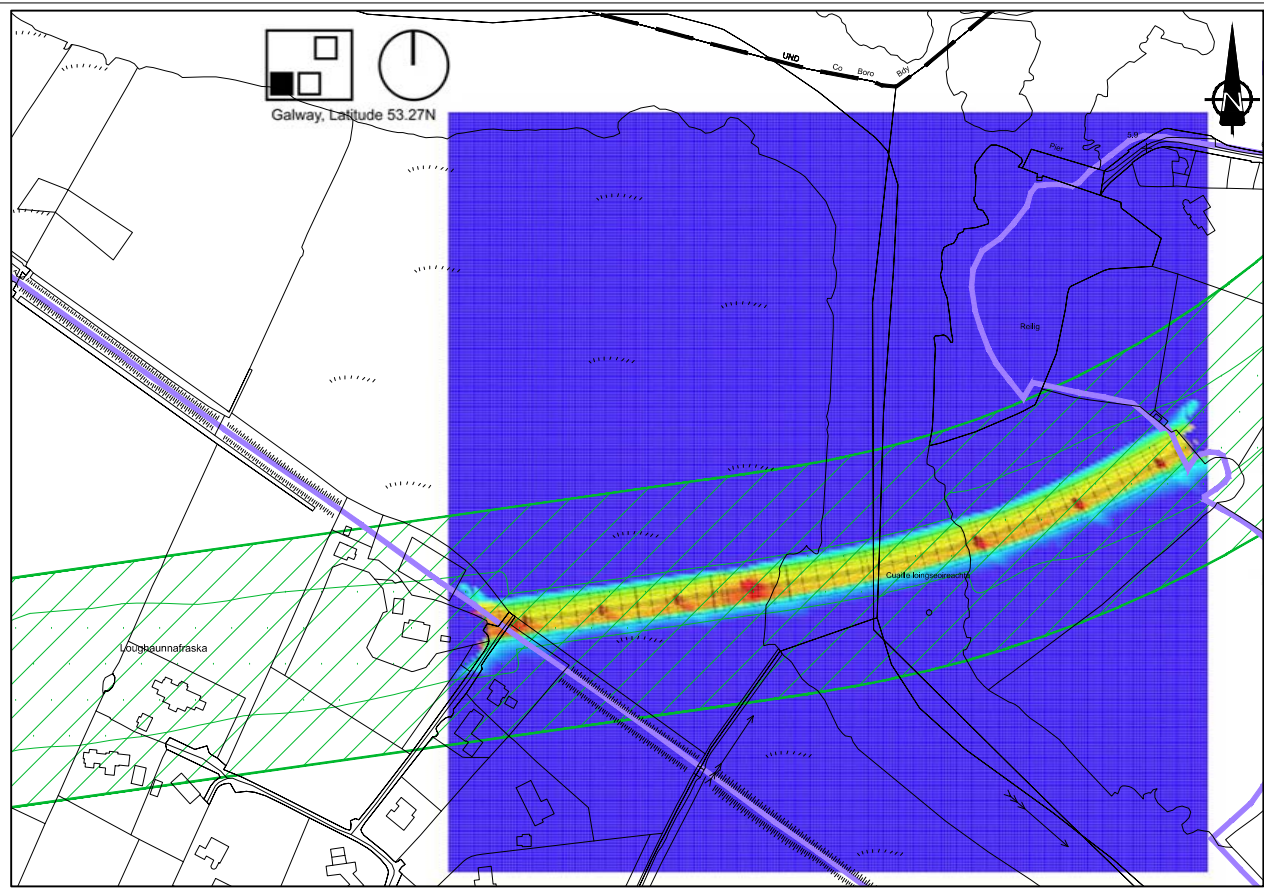

Solar access - June 21st

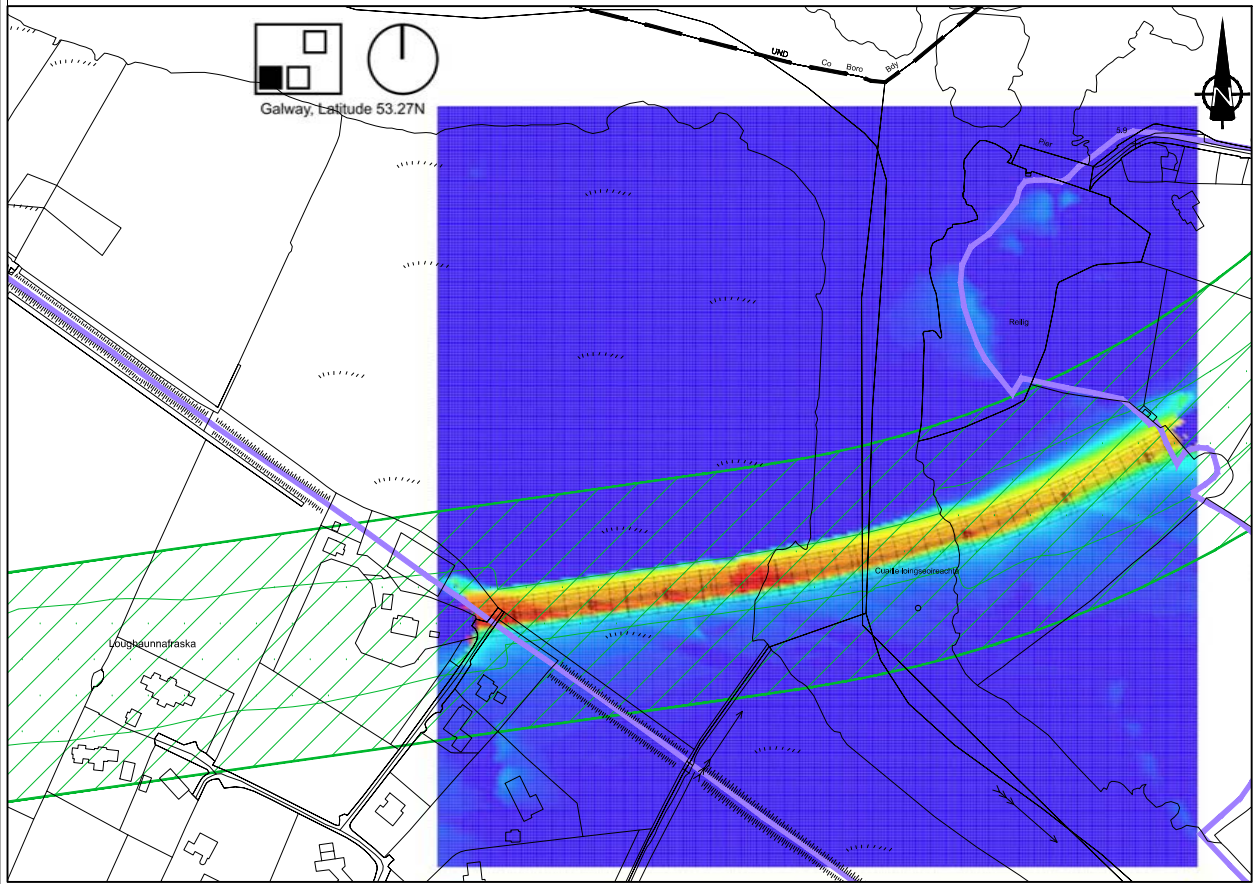

Solar access - April 21st

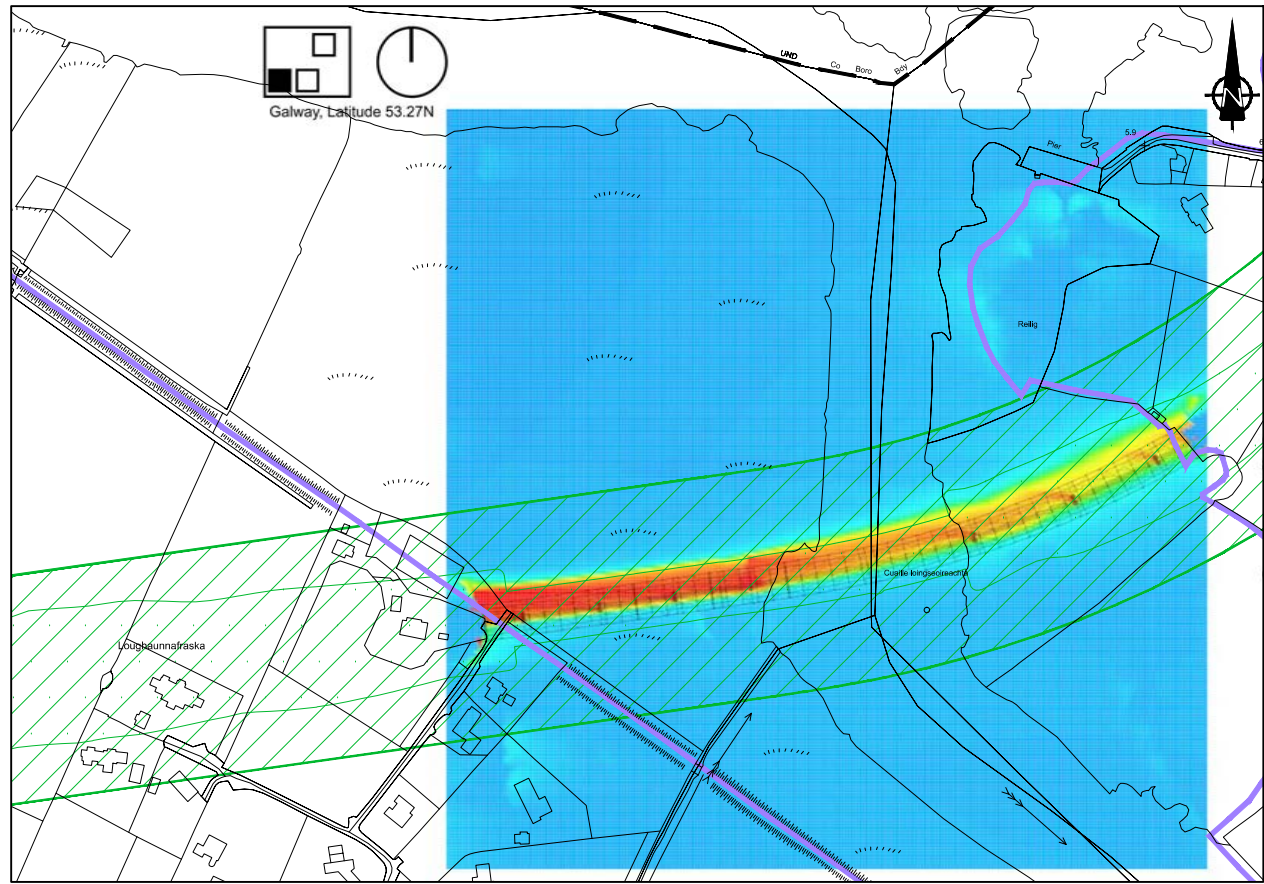

Solar access - September 21st

ROUTE SELECTION

- Legend:
- City Boundary
 - Green2 Route Option
 - cSAC Boundary

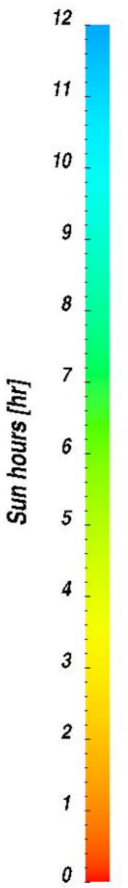

San áireamh tá sonraíocht Shuirbhéireacht Ordánais Éireann arna atáirgeadh faoi Chreidimís OSI Uimh. 2010/15CCMA/Comhairle Contae na Galillíne. Síraíonn atáirgeadh neamhdánaithe cúlpháirt Shuirbhéireacht Ordánais Éireann agus Rialtas na hÉireann. © Suirbhéireacht Ordánais Éireann, 2010.

Includes Ordnance Survey Ireland data reproduced under OSI Licence number 2010/15CCMA/Galway County Council. Unauthorised reproduction infringes Ordnance Survey Ireland and Government of Ireland copyright. © Ordnance Survey Ireland, 2010.

Disclaimer Note:
The constraints and options shown are draft only and subject to change. More detailed assessments, on-going studies and the information received from the public may result in changes to these constraints and options.

Nóta Séanta:
Tá na srianta agus na roghanna atá léirithe ina bhfoirm dréacht, d'fhéadfaí athraithe teacht orthu. Is mar thoradh ar mheasúnaithe níos mionchruinne, ar staidéar leanúnach agus ar eolas ón bpobal go ndéanfar athruithe ar na srianta agus na roghanna seo.

Clients

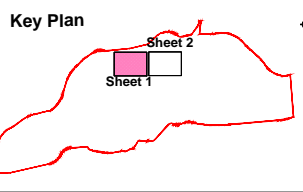

Consultant

Corporate House
City East Business Park
Ballybrit, Galway, Ireland.

Tel +353 (0)91 460675
www.N6GalwayCity.ie
www.arup.ie

Job Title
N6 Galway City Transport Project

Scale
1:5,000 @ A3

Date
September 2015

Issue	Date	By	Chkd	Appd
11	09/09/2015	KJ	FP	EMC

Drawing Title
**Article 6 Assessment
Project Appraisal Shading Analysis
Green2 Route Option (Sunlight Hours) - Sheet 1 of 2**

Drawing Status
Route Selection

Job No
233985-00

Drawing No
Figure 7.1

Issue
11